

Soils Map

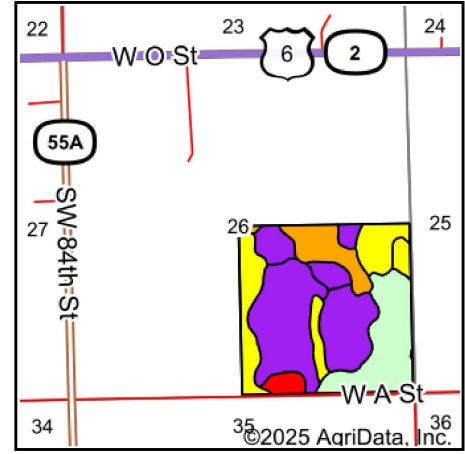

State: **Nebraska**
 County: **Lancaster**
 Location: **26-10N-5E**
 Township: **Middle Creek**
 Acres: **159.15**
 Date: **1/23/2025**

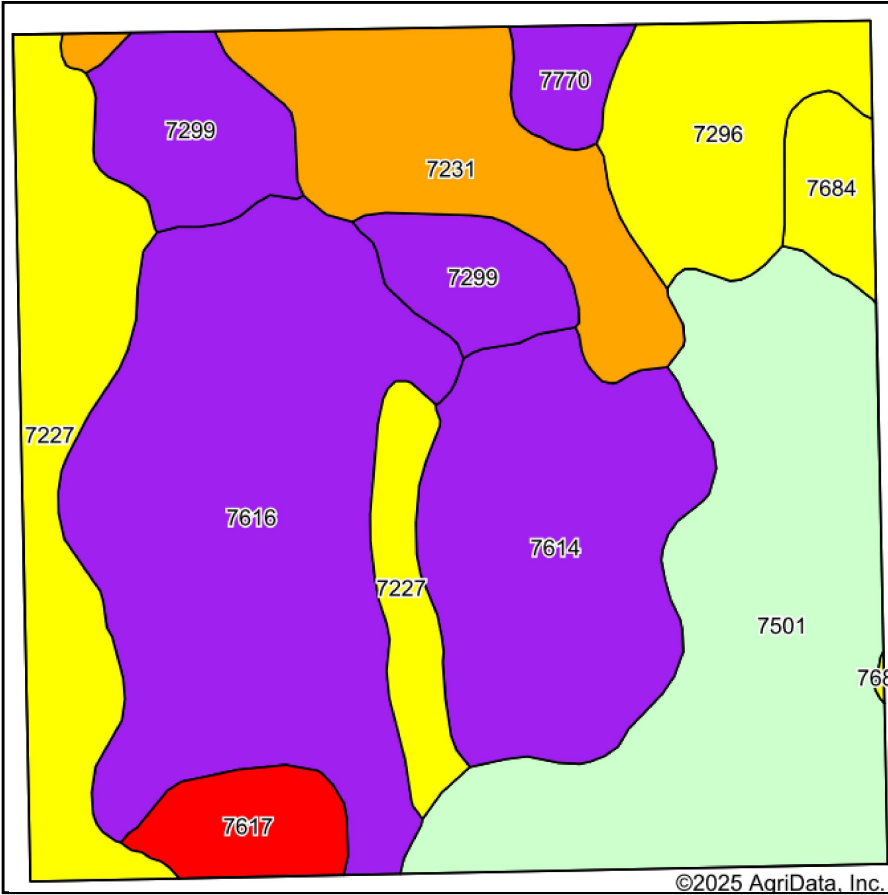

Soils data provided by USDA and NRCS.

Area Symbol: NE109, Soil Area Version: 29

Code	Soil Description	Acres	Percent of field	SRPG Legend	Non-Irr Class *c	Irr Class *c	Range Production (lbs/acre/yr)	SRPG	*n NCCPI Soybeans
7616	Steinauer loam, 6 to 11 percent slopes	37.35	23.5%		IVe		2763	56	68
7501	Pawnee clay loam, 4 to 8 percent slopes, eroded	32.83	20.6%		IIIe		3883		39
7614	Steinauer clay loam, 6 to 11 percent slopes, eroded	21.35	13.4%		IVe		2925	55	61
7227	Burchard clay loam, 6 to 11 percent slopes	20.27	12.7%		IIIe	IVe	3400	68	54
7231	Judson silt loam, 2 to 6 percent slopes	14.99	9.4%		IIe		4224	74	71
7299	Malcolm silt loam, 11 to 25 percent slopes	11.39	7.2%		VIe		3613	51	60
7296	Malcolm silt loam, 6 to 11 percent slopes	10.68	6.7%		IVe		3613	68	71
7617	Steinauer loam, 11 to 30 percent slopes	4.38	2.8%		VIe		2763	33	53
7684	Wymore silty clay loam, 3 to 6 percent slopes, eroded	3.36	2.1%		IIIe	IVe	3832	70	50
7770	Colo silty clay loam, occasionally flooded	2.55	1.6%		IIw		4250	57	62
Weighted Average					3.62	*-	3398.8	47.7	*n 58.3

*n: The aggregation method is "Weighted Average using all components"

*c: Using Capabilities Class Dominant Condition Aggregation Method

*- Irr Class weighted average cannot be calculated on the current soils data due to missing data.