

Tract #3 Soils Map

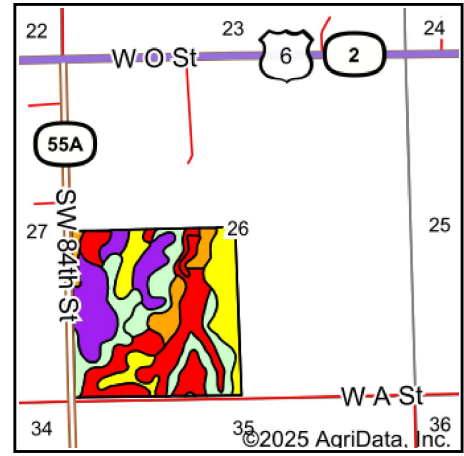

State: **Nebraska**
 County: **Lancaster**
 Location: **26-10N-5E**
 Township: **Middle Creek**
 Acres: **152.84**
 Date: **1/23/2025**

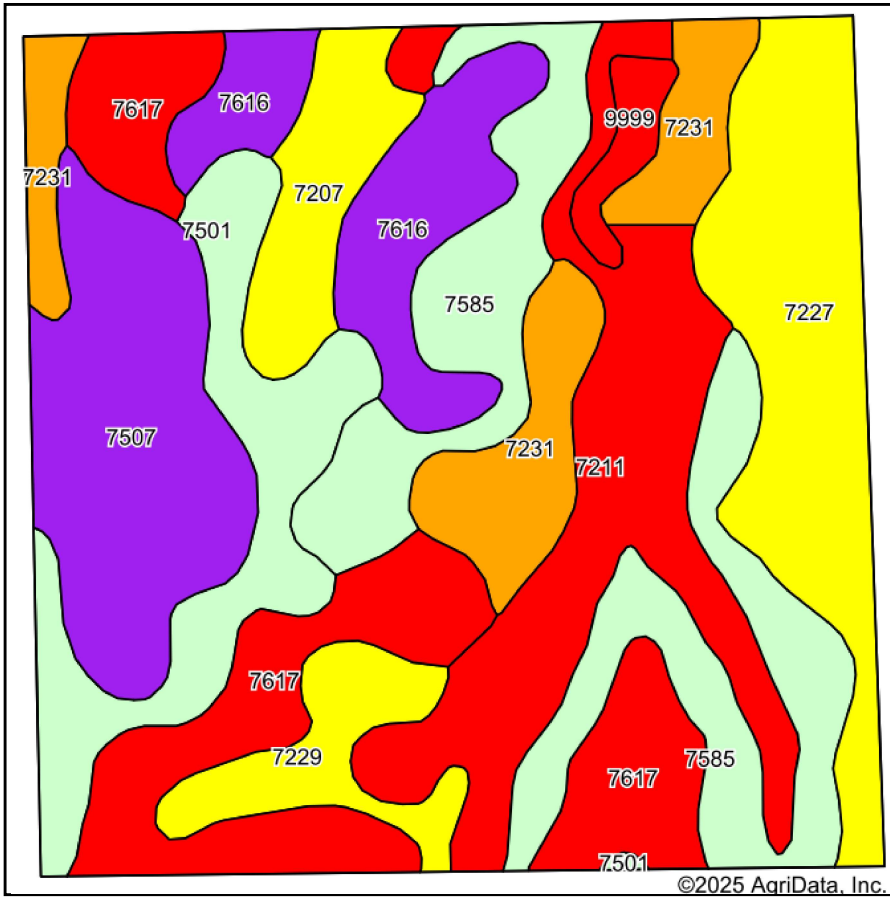

Soils data provided by USDA and NRCS.

Area Symbol: NE109, Soil Area Version: 29

Code	Soil Description	Acres	Percent of field	SRPG Legend	Non-Irr Class *c	Irr Class *c	Range Production (lbs/acre/yr)	SRPG	*n NCCPI Soybeans	
7585	Shelby clay loam, 7 to 12 percent slopes	23.44	15.3%			IVe		4260	60	
7617	Steinauer loam, 11 to 30 percent slopes	21.48	14.1%			VIe		2763	33	
7211	Burchard-Nodaway complex, 2 to 30 percent slopes	20.78	13.6%			VIe		3200	44	
7227	Burchard clay loam, 6 to 11 percent slopes	18.41	12.0%			IIIe	IVe	3400	68	
7507	Pawnee clay loam, 6 to 11 percent slopes, eroded	17.44	11.4%			IVe		3750	58	
7501	Pawnee clay loam, 4 to 8 percent slopes, eroded	13.39	8.8%			IIIe		3883	39	
7231	Judson silt loam, 2 to 6 percent slopes	12.26	8.0%			IIe		4224	74	
7616	Steinauer loam, 6 to 11 percent slopes	11.11	7.3%			IVe		2763	56	
7207	Aksarben silty clay loam, 6 to 11 percent slopes	6.50	4.3%			IIIe	IVe	3400	68	
7229	Burchard clay loam, 11 to 17 percent slopes	6.03	3.9%			IVe		3400	62	
9999	Water	2.00	1.3%					0	0	
Weighted Average						*-	*-	3472.7	40.8	*n 52.4

*n: The aggregation method is "Weighted Average using all components"

*c: Using Capabilities Class Dominant Condition Aggregation Method

*- Non Irr Class weighted average cannot be calculated on the current soils data due to missing data.

*- Irr Class weighted average cannot be calculated on the current soils data due to missing data.