

# Tract #1 Soils Map

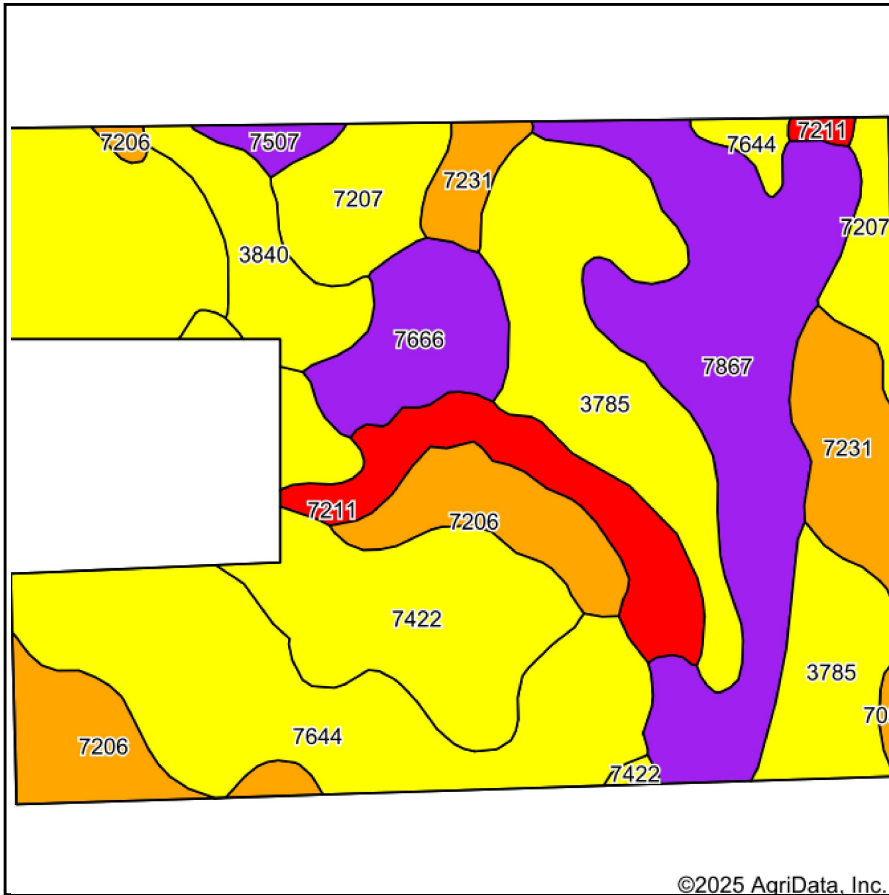

©2025 AgriData, Inc.

Soils data provided by USDA and NRCS.

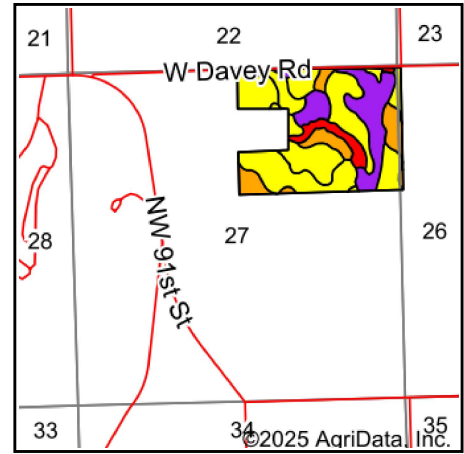

State: **Nebraska**  
 County: **Lancaster**  
 Location: **27-12N-5E**  
 Township: **West Oak**  
 Acres: **106.56**  
 Date: **1/23/2025**



Maps Provided By:



© AgriData, Inc. 2023

www.AgriDataInc.com



Area Symbol: NE109, Soil Area Version: 29

Code	Soil Description	Acres	Percent of field	SRPG Legend	Non-Irr Class *c	Irr Class *c	Range Production (lbs/acre/yr)	SRPG	Corn Bu	Corn Irrigated Bu	*n NCCPI Soybeans
7644	Yutan silty clay loam, 6 to 11 percent slopes, eroded	24.87	23.3%		IIle	IVe	3995	67	77	94	58
7867	Nodaway silt loam, channeled, frequently flooded	17.01	16.0%		VIw		2565	59	4	5	42
3785	Crete silty clay loam, terrace, 1 to 3 percent slopes	16.35	15.3%		Ile	Ile	4100	69	79	126	64
7422	Morrill clay loam, 6 to 11 percent slopes, eroded	11.22	10.5%		IVe	IVe	3400	68			54
7206	Aksarben silty clay loam, 2 to 6 percent slopes	8.41	7.9%		Ile	IIIe	4205	72			60
7207	Aksarben silty clay loam, 6 to 11 percent slopes	6.27	5.9%		IIIe	IVe	3400	68			61
7211	Burchard-Nodaway complex, 2 to 30 percent slopes	6.12	5.7%		VIe		3200	44			45
7231	Judson silt loam, 2 to 6 percent slopes	5.98	5.6%		Ile		4224	74			71
7666	Mayberry silty clay loam, 3 to 6 percent slopes, eroded	4.97	4.7%		IVe	IVe	3230	60			44
3840	Geary silty clay loam, 7 to 11 percent slopes, eroded	4.12	3.9%		IVe	IVe	3825	70			63

Soils data provided by USDA and NRCS.



Code	Soil Description	Acres	Percent of field	SRPG Legend	Non-Irr Class *c	Irr Class *c	Range Production (lbs/acre/yr)	SRPG	Corn Bu	Corn Irrigated Bu	*n NCCPI Soybeans
7507	Pawnee clay loam, 6 to 11 percent slopes, eroded	0.83	0.8%		Ive		3750	58			39
7050	Kennebec silt loam, occasionally flooded	0.41	0.4%		llw		4361	73	114		82
<b>Weighted Average</b>					<b>3.56</b>	<b>*-</b>	<b>3626.2</b>	<b>65.4</b>	<b>31.2</b>	<b>42.1</b>	<b>*n 55.7</b>

\*n: The aggregation method is "Weighted Average using all components"

\*c: Using Capabilities Class Dominant Condition Aggregation Method

\*- Irr Class weighted average cannot be calculated on the current soils data due to missing data.