

Soils Map

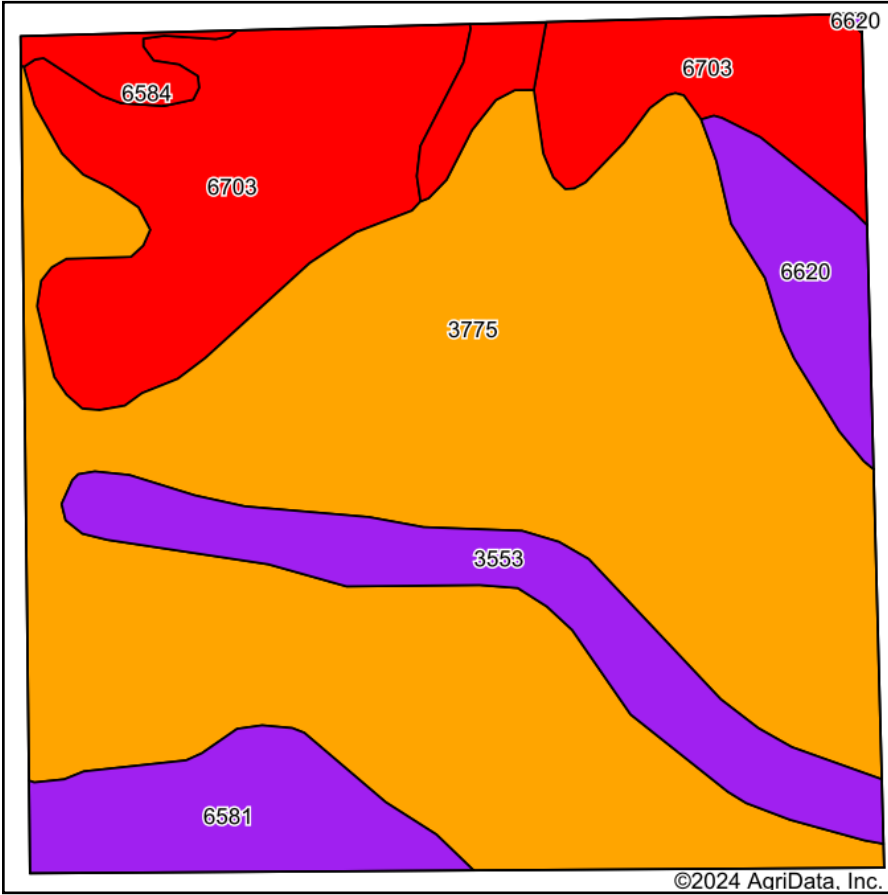

Soils data provided by USDA and NRCS.

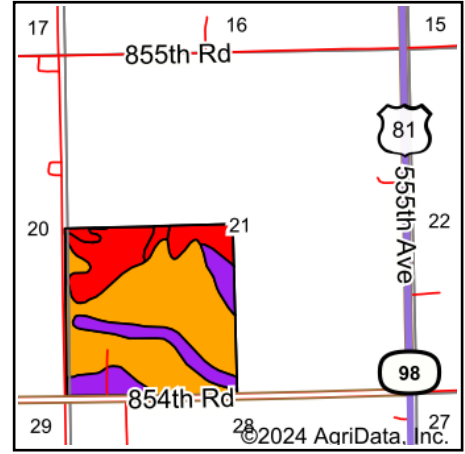

State: **Nebraska**
 County: **Pierce**
 Location: **21-26N-1W**
 Township: **Slough**
 Acres: **154.34**
 Date: **12/20/2024**



Maps Provided By:



© AgriData, Inc. 2023

www.AgriDataInc.com



Area Symbol: NE139, Soil Area Version: 23

Code	Soil Description	Acres	Percent of field	SRPG Legend	Non-Irr Class *c	Irr Class *c	Range Production (lbs/acre/yr)	SRPG	Corn Bu	Corn Irrigated Bu	*n NCCPI Soybeans
3775	Muir silt loam, 0 to 2 percent slopes, rarely flooded	92.34	59.9%		lw	le	4034	74			83
6703	Thurman loamy fine sand, 2 to 6 percent slopes	30.26	19.6%		IVe	IVe	3073	32			34
3553	Hobbs silt loam, 0 to 2 percent slopes, frequently flooded, cool	12.48	8.1%		VIw		3305	53			54
6581	Ortello loam, terrace, 0 to 1 percent slopes	9.46	6.1%		I	I	3300	60	60	135	48
6620	Bazile soils, 1 to 6 percent slopes	5.92	3.8%		IIIe	IIIe	2700	51	55	115	42
6584	Ortello fine sandy loam, terrace, 0 to 2 percent slopes	3.88	2.5%		Ile	Ile	3300	50	60	130	43
Weighted Average							3672	61.7	7.3	16	*n 66.3

*n: The aggregation method is "Weighted Average using all components"

*c: Using Capabilities Class Dominant Condition Aggregation Method

*- Irr Class weighted average cannot be calculated on the current soils data due to missing data.