

# Soils Map

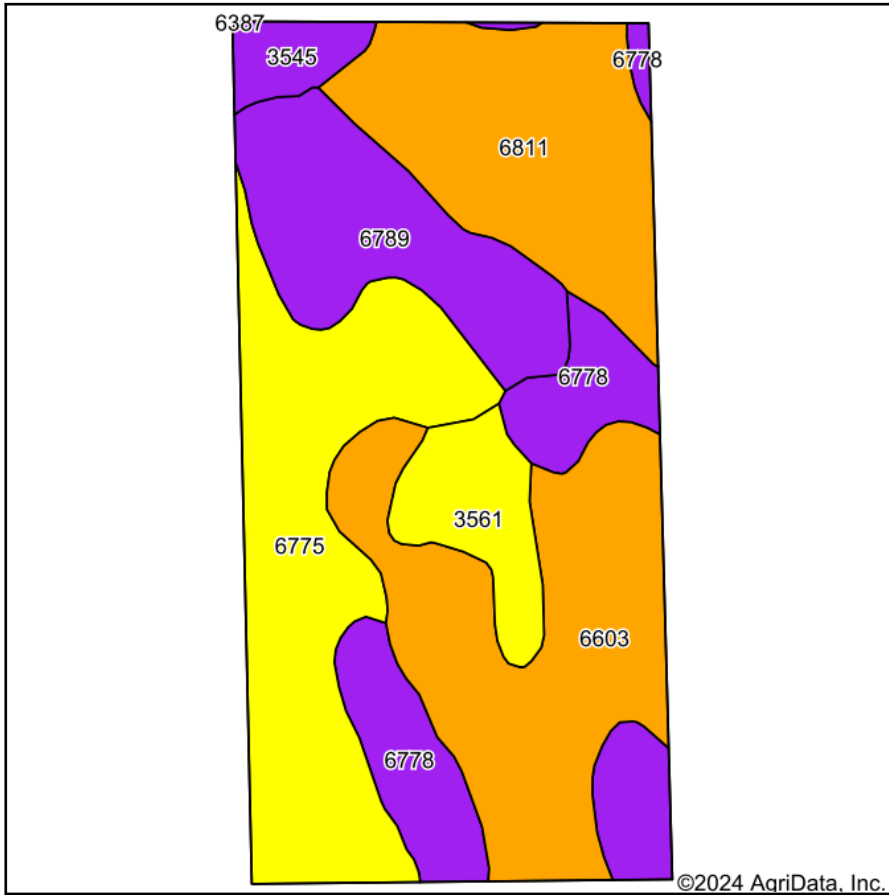

Soils data provided by USDA and NRCS.

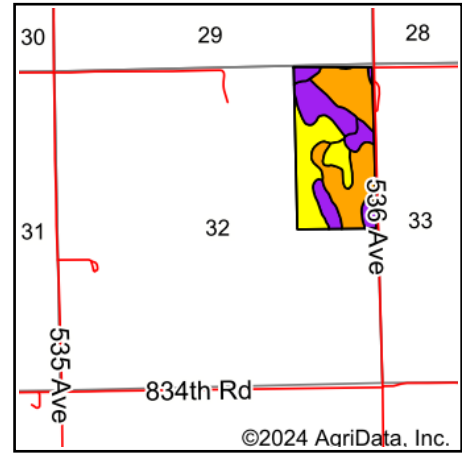

State: **Nebraska**  
 County: **Madison**  
 Location: **32-23N-4W**  
 Township: **Grove**  
 Acres: **80**  
 Date: **8/6/2024**



Area Symbol: NE119, Soil Area Version: 22

Code	Soil Description	Acres	Percent of field	SRPG Legend	Non-Irr Class *c	Irr Class *c	Range Production (lbs/acre/yr)	SRPG	Corn Bu	Corn Irrigated Bu	*n NCCPI Soybeans
6775	Nora-Crofton complex, 2 to 6 percent slopes, eroded	18.78	23.5%		Ile	IIIe	3275	61			68
6603	Alcester silty clay loam, 2 to 6 percent slopes	18.76	23.4%		Ile	IIIe	3498	73			72
6811	Moody silty clay loam, 2 to 6 percent slopes	14.49	18.1%		Ile	IIIe	3243	71			74
6789	Crofton-Nora complex, 11 to 17 percent slopes, eroded	10.63	13.3%		IVe		2995	52			61
6778	Nora-Crofton complex, 6 to 11 percent slopes, eroded	10.52	13.2%		IIIe	IVe	3350	57			66
3561	Hobbs silt loam, 0 to 2 percent slopes, occasionally flooded, cool	4.74	5.9%		IIw	IIw	3315	69			78
3545	Hobbs silt loam, channeled, 0 to 2 percent slopes, frequently flooded	2.08	2.6%		Vlw		3340	54			39
<b>Weighted Average</b>					<b>2.50</b>	<b>*-</b>	<b>3298.2</b>	<b>64.2</b>	<b>*-</b>	<b>*-</b>	<b>*n 68.7</b>

\*n: The aggregation method is "Weighted Average using all components"

\*c: Using Capabilities Class Dominant Condition Aggregation Method

\*- Irr Class weighted average cannot be calculated on the current soils data due to missing data.