

# Soils Map

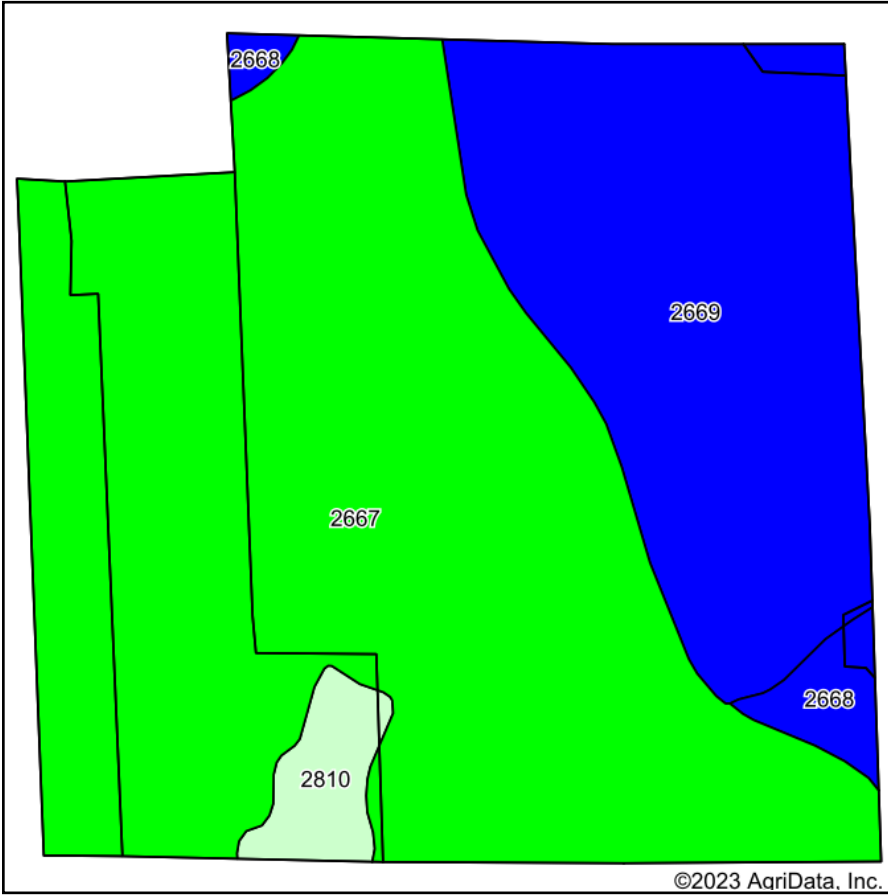

Soils data provided by USDA and NRCS.

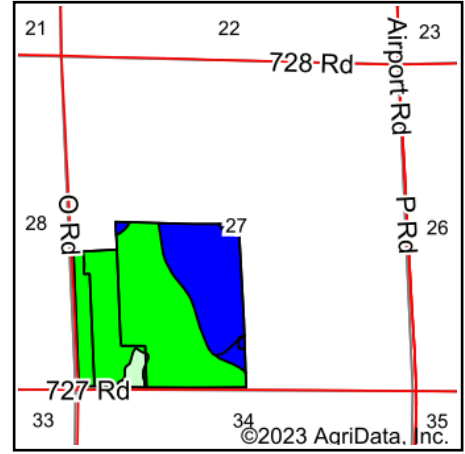

State: **Nebraska**  
 County: **Phelps**  
 Location: **27-5N-18W**  
 Township: **Prairie**  
 Acres: **149.8**  
 Date: **10/4/2023**



Area Symbol: NE137, Soil Area Version: 23

Code	Soil Description	Acres	Percent of field	Irr class Legend	Soil Drainage	Non-Irr Class	Irr Class	Range Production (lbs/acre/yr)	SRPG	*n NCCPI Overall	*n NCCPI Corn	*n NCCPI Soybeans
2667	Holdrege silt loam, 0 to 1 percent slopes	99.20	66.2%		Well drained	Ile	Iw	3661	69	80	60	80
2669	Holdrege silt loam, 1 to 3 percent slopes, eroded	43.16	28.8%		Well drained	Ile	Ile	3000	68	70	48	70
2810	Uly and Coly silt loams, 11 to 30 percent slopes	4.00	2.7%		Well drained	Vle		3015	34	65	46	65
2668	Holdrege silt loam, 1 to 3 percent slopes	3.44	2.3%		Well drained	Ile	Ile	3661	68	79	60	79
<b>Weighted Average</b>						<b>2.11</b>	<b>*-</b>	<b>3453.3</b>	<b>67.8</b>	<b>*n 76.7</b>	<b>*n 56.2</b>	<b>*n 76.7</b>

\*n: The aggregation method is "Weighted Average using all components"  
 \*- Irr Class weighted average cannot be calculated on the current soils data due to missing data.  
 Soils data provided by USDA and NRCS.