

Soils Map

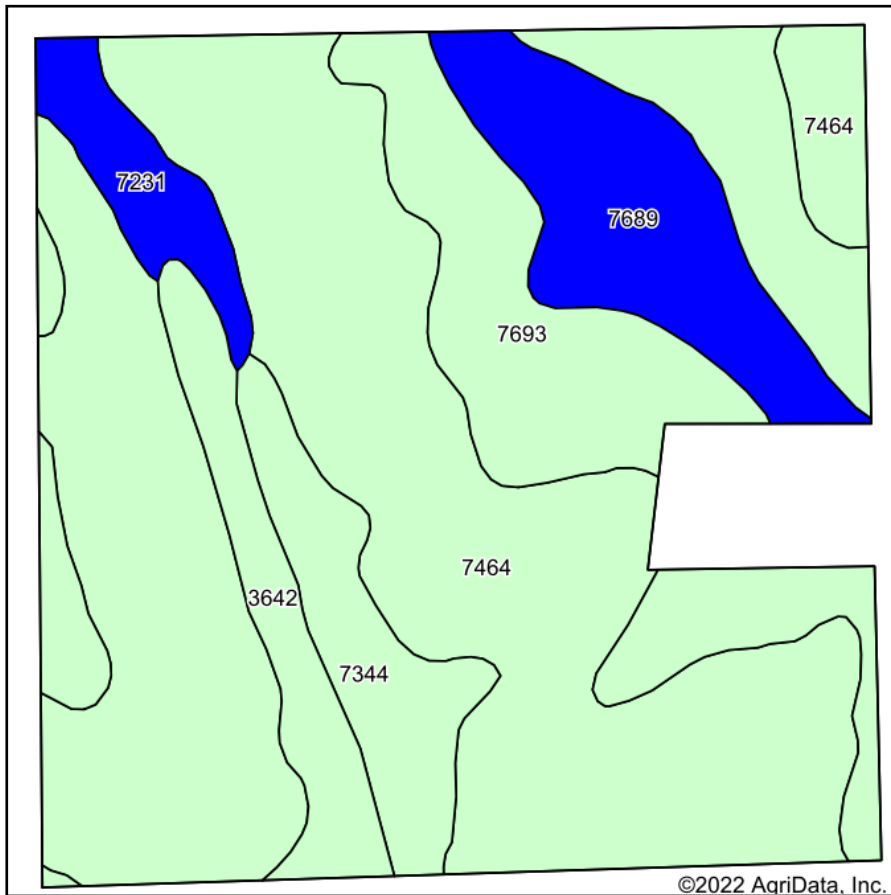

Soils data provided by USDA and NRCS.

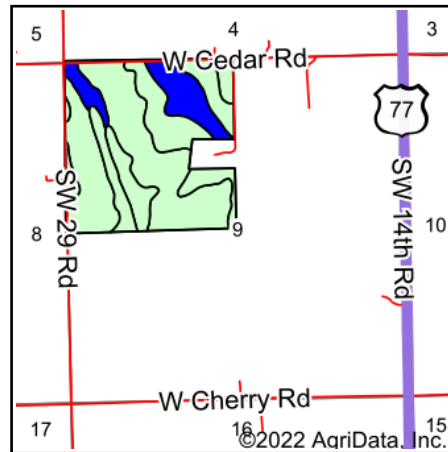

State: **Nebraska**
 County: **Gage**
 Location: **9-5N-6E**
 Township: **Holt**
 Acres: **152**
 Date: **9/29/2022**



Area Symbol: NE067, Soil Area Version: 24

Code	Soil Description	Acres	Percent of field	Non-Irr Class Legend	Non-Irr Class *c	Irr Class *c	Range Production (lbs/acre/yr)	SRPG	Corn Bu	Corn Irrigated Bu	*n NCCPI Soybeans
7464	Otoe silty clay loam, 6 to 11 percent slopes, eroded	79.96	52.6%		IVe		3188	66			49
7693	Wymore silty clay loam, 2 to 6 percent slopes	34.17	22.5%		IIIe	IIIe	3750	69			58
7689	Wymore silty clay loam, 0 to 2 percent slopes	14.70	9.7%		IIs	IIs	3751	72			61
7344	Malmo, eroded-Pawnee complex, 6 to 11 percent slopes	9.56	6.3%		IVe		3375	52			42
3642	Kezan silt loam, occasionally flooded	8.26	5.4%		Vw		5298	59	13	17	71
7231	Judson silt loam, 2 to 6 percent slopes	5.35	3.5%		Ile		4224	80			71
Weighted Average					3.57	*-	3531.7	66.5	0.7	0.9	*n 53.7

*n: The aggregation method is "Weighted Average using all components"

*c: Using Capabilities Class Dominant Condition Aggregation Method

*- Irr Class weighted average cannot be calculated on the current soils data due to missing data.

Soils data provided by USDA and NRCS.