

Soils Map

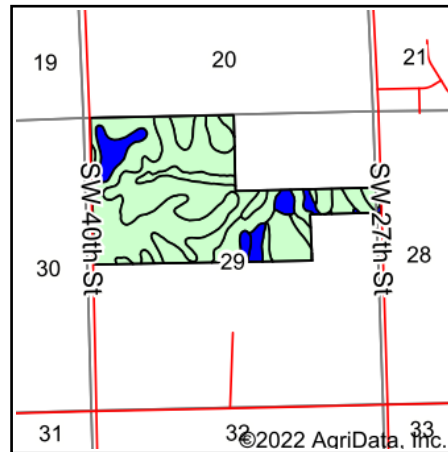

State: **Nebraska**
 County: **Lancaster**
 Location: **29-9N-6E**
 Township: **Yankee Hill**
 Acres: **214.74**
 Date: **8/15/2022**

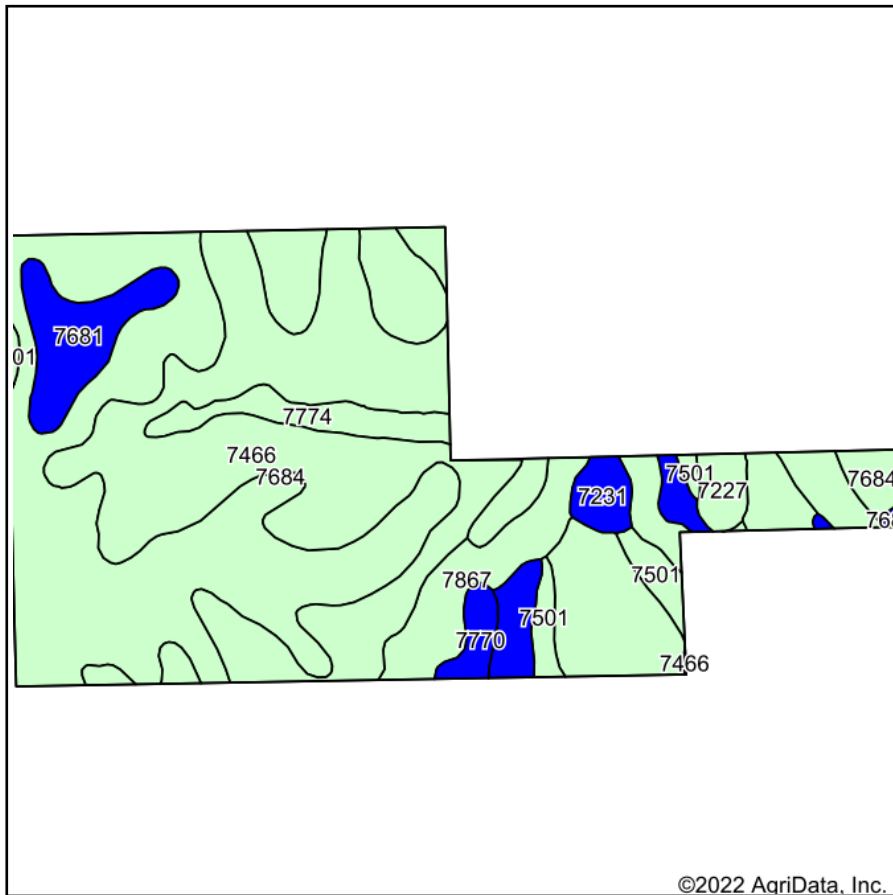

Soils data provided by USDA and NRCS.

Area Symbol: NE109, Soil Area Version: 26

Code	Soil Description	Acres	Percent of field	Non-Irr Class Legend	Non-Irr Class *c	Irr Class *c	Range Production (lbs/acre/yr)	SRPG	Corn Bu	Corn Irrigated Bu	*n NCCPI Soybeans
7684	Wymore silty clay loam, 3 to 6 percent slopes, eroded	92.28	43.0%		IIIe	IVe	3832	70			52
7466	Otoe silty clay, 6 to 11 percent slopes, eroded	71.11	33.1%		IVe	IVe	3750	66	83	133	49
7867	Nodaway silt loam, channeled, frequently flooded	13.58	6.3%		VIw		2565	59	4	5	43
7681	Wymore silty clay loam, 1 to 3 percent slopes	9.86	4.6%		Ile	Ile	3800	72			59
7774	Colo-Nodaway silty clay loams, frequently flooded	8.79	4.1%		IIIw		1520	60	72	100	59
7231	Judson silt loam, 2 to 6 percent slopes	8.34	3.9%		Ile		4224	74			71
7501	Pawnee clay loam, 4 to 8 percent slopes, eroded	5.36	2.5%		IIIe		3878				40
7227	Burchard clay loam, 6 to 11 percent slopes	2.82	1.3%		IIIe	IVe	3400	68			55
7770	Colo silty clay loam, occasionally flooded	2.60	1.2%		IIw		4250	57			62
Weighted Average					3.42	*-	3644.4	65.9	30.7	48.5	*n 51.6

*n: The aggregation method is "Weighted Average using all components"

*c: Using Capabilities Class Dominant Condition Aggregation Method

*- Irr Class weighted average cannot be calculated on the current soils data due to missing data.

Soils data provided by USDA and NRCS.