

# Soils Map

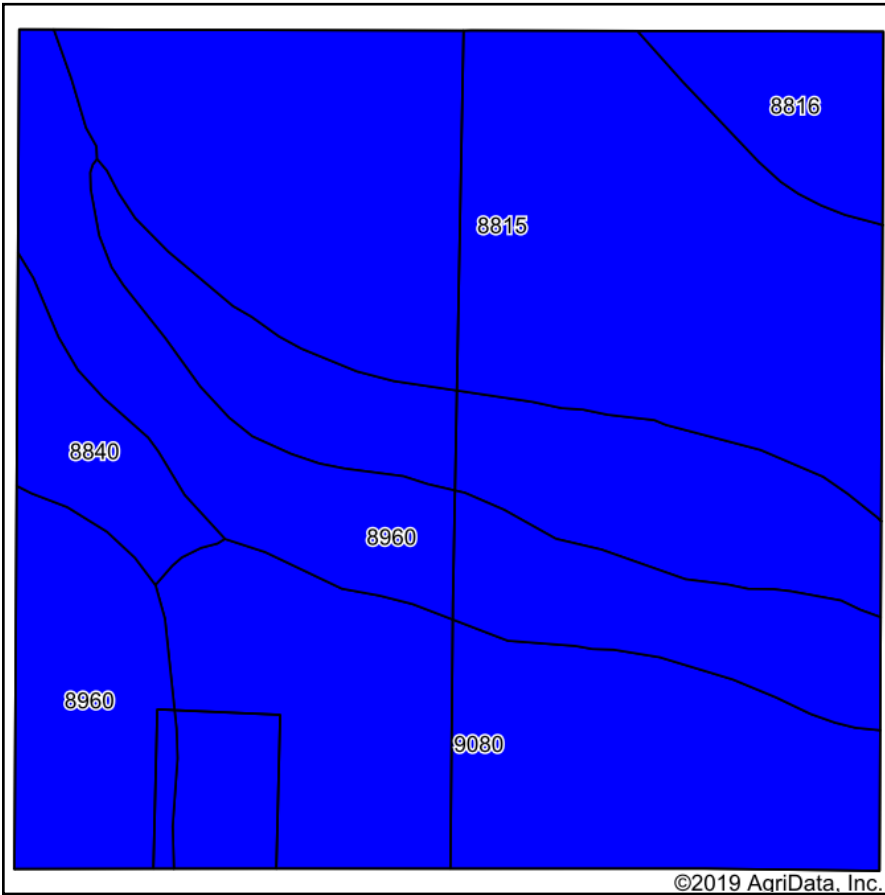

Soils data provided by USDA and NRCS.

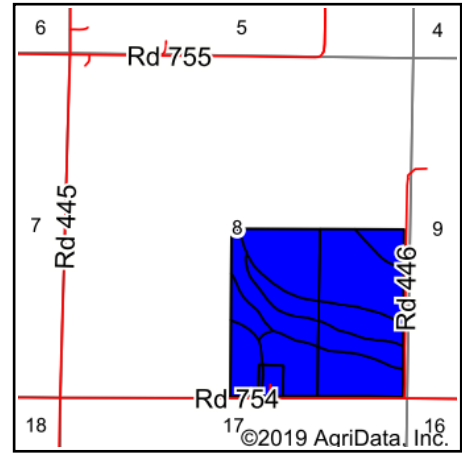

State: **Nebraska**  
 County: **Dawson**  
 Location: **8-9N-19W**  
 Township: **Overton**  
 Acres: **158.55**  
 Date: **7/8/2019**



Area Symbol: NE047. Soil Area Version: 16												
Cod e	Soil Description	Acres	Percent of field	Non-Irr Class Legend	Water Table	Non-Irr Class *c	Irr Class *c	Range Production (lbs/acre/yr)	SRPG	*n NCCPI Overall	*n NCCPI Corn	*n NCCPI Small Grains
9080	Rusco silt loam, 0 to 1 percent slopes	56.62	35.7%		0.5ft.	llw	llw	3724	34	38	22	16
8815	Cozad silt loam, 0 to 1 percent slopes	54.24	34.2%		> 6.5ft.	llc	lw	3767	67	68	60	48
8960	Wood River silt loam, 0 to 1 percent slopes	35.65	22.5%		> 6.5ft.	lls	lls	3000	47	36	15	25
8816	Cozad silt loam, 1 to 3 percent slopes	6.37	4.0%		> 6.5ft.	lle	lle	3762	66	58	40	42
8840	Hall silt loam, 0 to 1 percent slopes	5.67	3.6%		> 6.5ft.	llc	lw	4464	70	65	50	46
<b>Weighted Average</b>								<b>3603.9</b>	<b>50.8</b>	<b>*n 49.6</b>	<b>*n 35.2</b>	<b>*n 31.1</b>

\*n: The aggregation method is "Weighted Average using major components"

\*c: Using Capabilities Class Dominant Condition Aggregation Method

Soils data provided by USDA and NRCS.